

STACKER 10-23



STACKERS



DIMENSIONS

OPERATION:

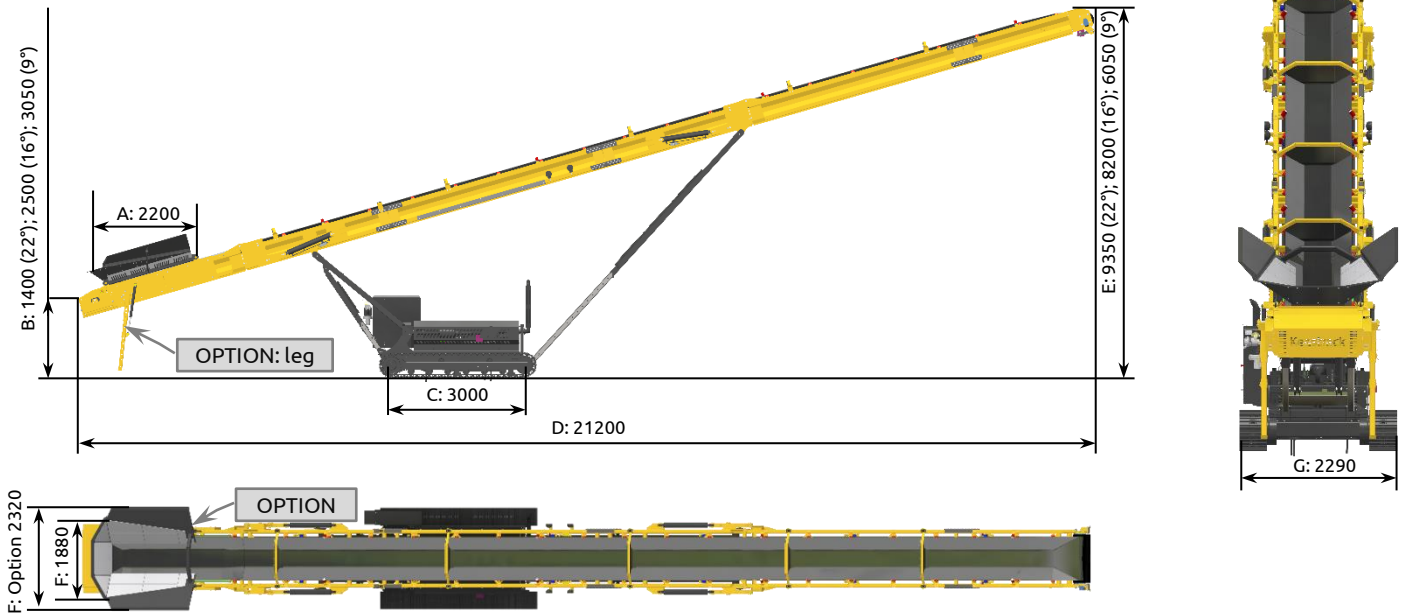

Weight: approx. 12,2 t (without options)

Weight options:
 Wear lining feeding chute + approx. 193 kg
 Increased feeding chute + approx. 200 kg
 Hydraulic supporting legs + approx. 214 kg

Total weight with options approx. 12,8 t

Transport width 2.290 mm (9'10")



TRANSPORT:

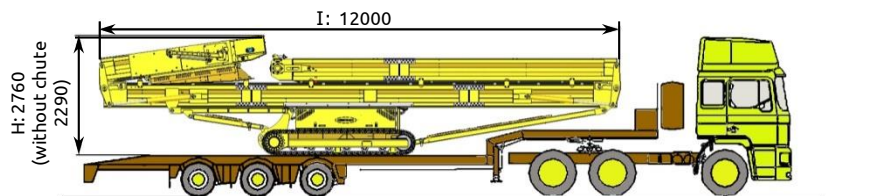

REMARK: All pictures might show options, not included in the scope of supply

A	B	C	D	E	F	G	H	H w/o chute	I
2200	1400	3000	21200	9350	1880	2290	2760	2290	12000
7'3"	4'7"	9'10"	69'7"	30'8"	6'2"	7'6"	9'0"	7'6"	39'4"

TECHNICAL SPECIFICATION

APPLICATION:

Stockpiling of bulk goods (sand and gravel)

- Feed size	0 up to max. 200 mm		
- Feed capacity	Depending on the inclination of the conveyor: Inclination 22°: up to 300 T.P.H.(with engine 35,2 kW – p/n 103008)		
- Stockpile capacity	Depending on the swivelling of the conveyor (estimations: angle of repose 37 °; bulk weight 1,7 kg/dm³):		
	Swivelling 0 °	Inclination 22°	2.500 tons
	Swivelling 90 °	Inclination 22°	8.600 tons
	Swivelling 180 °	Inclination 22°	15.000 tons
- Possible Inclinations	In steps of approx. 2° from 9° to 22°		

1) FEEDING CHUTE

- Model	04 FEH 000000-000		
- Design	Made of St 520-3		
- Wear plates (Option)	Wear resistant steel HB 450; s=10 mm or rubber	(4'7"-10'0")	
- Feeding height	1.400 – 3.050 mm; can be varied to higher positions by swivelling the feed end of the conveyor hydraulically	(7'3")	
- Feeding length lateral	2.200 mm		

2) MAIN BELT CONVEYOR

- Model	04 MCL 000000-000 E		
- Length	23.000 mm	(75'6")	
- Width	1.000 mm	(3'4")	
- Capacity	Up to 500 T.P.H.		
- Drive	E-drum motor 22,5 kW with frequency inverter	(30,6 hp)	
- Belt speed	2,2 m/s	(7,2 ft/s)	
- Rubber belt quality	EP 400/3 4+2		
- Troughing	30°; 3 parts		
- Feeding zone	With PU impact bars		
- For transport	2 x hydraulically fold-able		

3) TRACK - UNIT

- Model	04 TRA-100-00		
- Length	3.000 mm	(9'10")	
- Width track shoe	400 mm	(1'6")	
- Total width	2.290 mm	(7'6")	
- Speed	1 km/h	(0,6 mph)	
- Drive	Hydraulic motor and planetary gears		

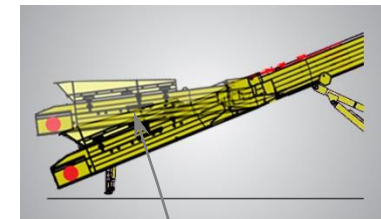
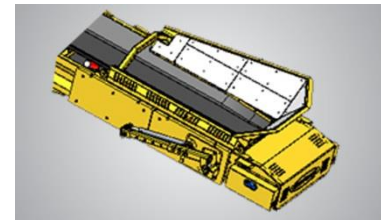

Swivelled-up feeding zone

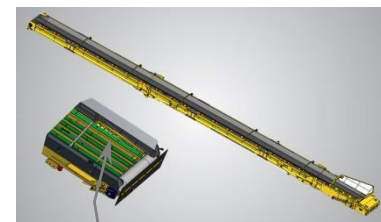

Feeding zone



TECHNICAL SPECIFICATION

4) ENGINE UNIT

- Model	04 ENU 000000-000	
- Diesel engine type	a) DEUTZ TCD 2.9 L4, 4 cylinder in-line b) DEUTZ D 2011 L 04, fixed speed	(p/n 101322) (p/n 103008)
- Emission control	a) Tier 4i; EU STAGE IIIB; DOC Option: DPF (p/n 101323) b) Tier 3; EU STAGE IIIA; EGR	Latest technology
- Power acc. to ISO 14396	a) 48 kW at 1.500 R.P.M.; 55,4 kW at 2.000 R.P.M. b) 29,4 kW at 1.500 R.P.M.	(65 hp; 75 hp) (48 hp)
- Max. torque	a) 300 Nm / 1.500 Nm b) 190 Nm / 1.500 Nm	(221 lb ft) (140 lb ft)
- Engine speed	1.500 R.P.M.	
- Bore / Stroke	a) 92 / 110 mm b) 96 / 125 mm	(3,6" x 4,3") (3,8" x 4,9")
- Displacement	a) 2.920 cm ³ b) 3.620 cm ³	(178 cu in) (221 cu in)
- Voltage	24 Volt; for improved cold start properties	
- Battery	110 Ah-850 A	
- Electrical starter	24 Volt; for improved cold start properties	
- Alternator	26 Volt	
- Engine Operation	4-stroke Diesel direct injection	
- Cooling	a) water cooled b) air cooled	
- Fuel tank	230 litres	(60 gal)
- Fuel pre-filter	with water separator	
- Fuel code	according to DIN 51601	
- Consumption	a) 215 g/kWh / 1.500 R.P.M.; approx. 6 l/h b) 226 g/kWh / 1.500 R.P.M.; approx. 6 l/h	
- Generator	ECO 32-3L/4b; 75 kVA; 400 V; 50 Hz	
ATTENTION	<i>Engine warranty expires in case non genuine Keestrack filters are used!</i>	

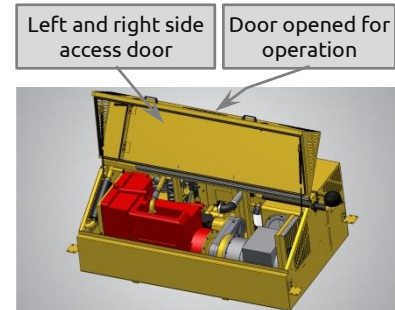

ep+:
Socket for external power supply



5) HYDRAULIC

Hydraulic main pump	Variable flow, swash plate pump load sense open loop circuit 60 cc	
Max. flow	90 l/min at 1.500 R.P.M.	(24 gpm)
Max. pressure	265 bar	(3.770 psi)
Pump regulation	servo hydraulic load sensing regulation, pressure compensation, flow compensation automatic flow optimizer	
Hydraulic tank	80 l	(34 gal)
Hydraulic oil filter	1 full flow filter in return line with integrated fine filter area (10 µm)	
Hydraulic oil cooler	Compact cooler, consisting of an electrical 12 Volt driven fan	
Hydraulic valves	PVG 32 proportional 3 bank valve	
Manual pump	25 ccm	
Hydraulic cylinders	A) folding and B) lifting of the conveyor (min./max. 9/22°)	

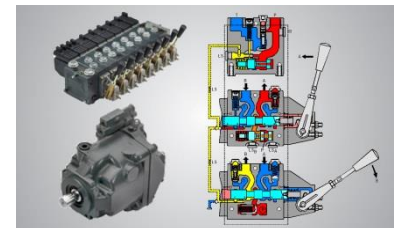

STACKERS

6) CONTROL

- Operation	Control panel
- Controller	Wired remote controller for tracks
- Power supply	a) Via built on diesel gen set or b) Via external power supply from net or external gen set (400 V; 3 phase; 50 Hz; ca. 63 A)

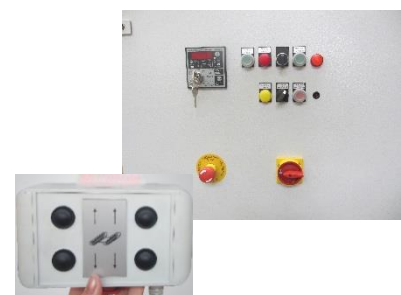

TECHNICAL SPECIFICATION - OPTIONS

11) WEAR LINING FEEDING CHUTE p/n 701030

- Rubber	p/n 704001; s = 10 mm	
- Steel	p/n 704002; s = 10 mm; HB 450	
- Weight	rubber 80 kg; steel 193 kg	(400 lb)

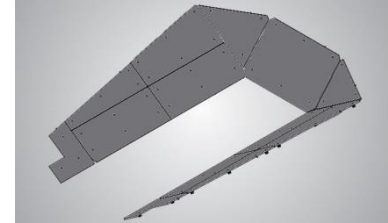

12) INCREASED FEEDING CHUTE p/n 695690 + 695695

- Width	2.320 mm	(7'7")
- Sides	Left and right side	
- Transport	Manually foldable	
- Weight	200 kg	(420 lb)

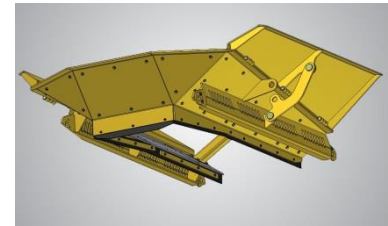

13) OIL LEVEL SENSOR p/n 105569

- Measuring signals	Temperature and level
---------------------	-----------------------

14) HARD METAL SCRAPER p/n 101807

- Location	Drive drum
------------	------------



15) FEEDING HOPPER WITH CONTAINER PLATFORM Model: 04 TRP 150

HOPPER		
- Volume	From GALLEON 8 m ³	(9 yard ³)
- Hopper walls	Hydraulically foldable	
- Feeding height / width	2.100 mm / 3.315 mm	(6'11" / 10'11")
BELT FEEDER		
- Full adjustable speed	From GALLEON With frequency inverter 20 - 100 Hz; 3,2 - 16,2 m/min	(10 - 53 ft/min)
- Axle distance	4.400 mm	(14'4")
- Plate width	1.200 mm	(3'11")
- Drive	E-motor 5,5 kW / 50 Hz; 11 kW / 100 Hz; with gearbox 8 R.P.M. / 50 Hz	(7,5/15 hp)
- Feed capacity	500 T.P.H.	

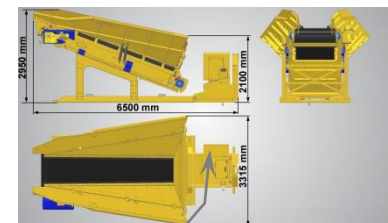

Switch cabinet Hydraulic for folding hopper walls

SUBSTRUCTURE

- Mobility	Container-mobile for hook lift truck	
- Hydraulic	For folding hopper walls; with E-motor 3 kW and gear pump	
- Transport dimensions	L=6.500 mm; W=2.550 mm; H=2.700 mm	(L: 21'4"; W: 8'4"; H: 8'10")
- Total weight	ca. 8.000 kg (incl. feeder and substructure)	(17.600 lb)

POWER SUPPLY	Via STACKER ep+ with extra strong engine unit and generator 63 kVA
---------------------	--

TECHNICAL SPECIFICATION - OPTIONS

16) FEEDING HOPPER WITH SUBSTRUCTURE a) p/n 618300; b) 694120

HOPPER	From FRONTIER 01 incl. corner extensions	
- Volume	9 m ³ (OPTION: with XXL hopper extension p/n 619315: 20 m ³ + 1.800 kg)	(11 / 24 yard ³) (3.968 lb)
- Hopper walls	Mechanically foldable	
- Feeding height / width	a) 2.770 mm; b) 2.465 mm / W=4.100 mm	(9'2" / 13'5")
- Total weight (incl. feeder and substructure)	a) ca. 8.250 kg; b) ca. 8.000 kg	(17.200 lb)
APRON FEEDER		
- Full adjustable speed	With frequency inverter 20 - 100 Hz; 3,2 - 16,2 m/min	(10 - 53 ft/min)
- Axle distance	3.560 mm	(11'8")
- Plate width	1.300 mm	(4'3")
- Drive (p/n 617610)	E-motor 5,5 kW / 50 Hz; 11 kW / 100 Hz; with gearbox 8 R.P.M. / 50 Hz	(7,5 / 15 hp)
- Feed capacity	500 T.P.H.	
SUBSTRUCTURE	a) 04 TRP 100-00; b) 04 TRP 400-00	
- Mobility	a) Semi-mobile b) Semi mobile for transport with fork lift	
- Transport dimensions	a) L=4.990; W=2.500; H=2.615 mm b) L=4.990; W=2.500; H=2.310 mm	(L: 16'5"; W: 8'2"; H: 8'7")
- Weight	a) 2.020 kg; b) ca. 1770 kg	(4.150 lb)
POWER SUPPLY	Via STACKER ep+ with extra strong engine unit and generator 63 kVA	

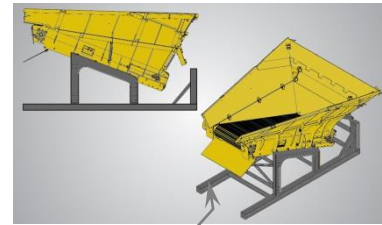

Substructure
04 TRP 100

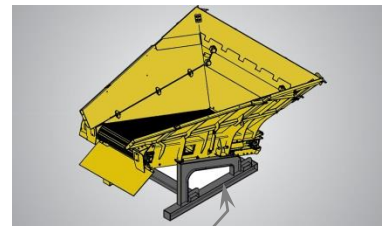

Substructure
04 TRP 400

17) CHEVRON RUBBER BELT p/n 102905

- Rubber belt quality	EP 400/3 4+2
- Cleats	750 mm x 25 mm

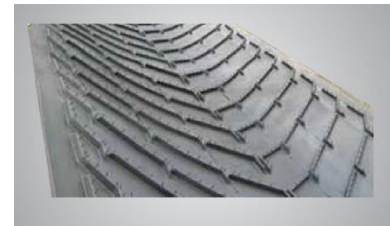

18) CHEVRON RUBBER BELT, ARCTIC DUTY p/n 100897

- Rubber belt quality	EP 400/3 3+1
- Cleats	750 mm x 25 mm

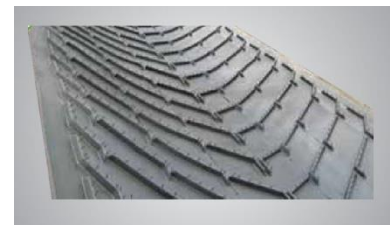

19) RUBBER PADS FOR TRACK CHAIN p/n 100632

- Arranged	bolted to the track chain elements	
- Number	106	
- Dimensions	400 x 106 x 40 mm	
- Weight	306 kg	(650 lb)

