



STACKER 10-23



STACKERS



DIMENSIONS

OPERATION:

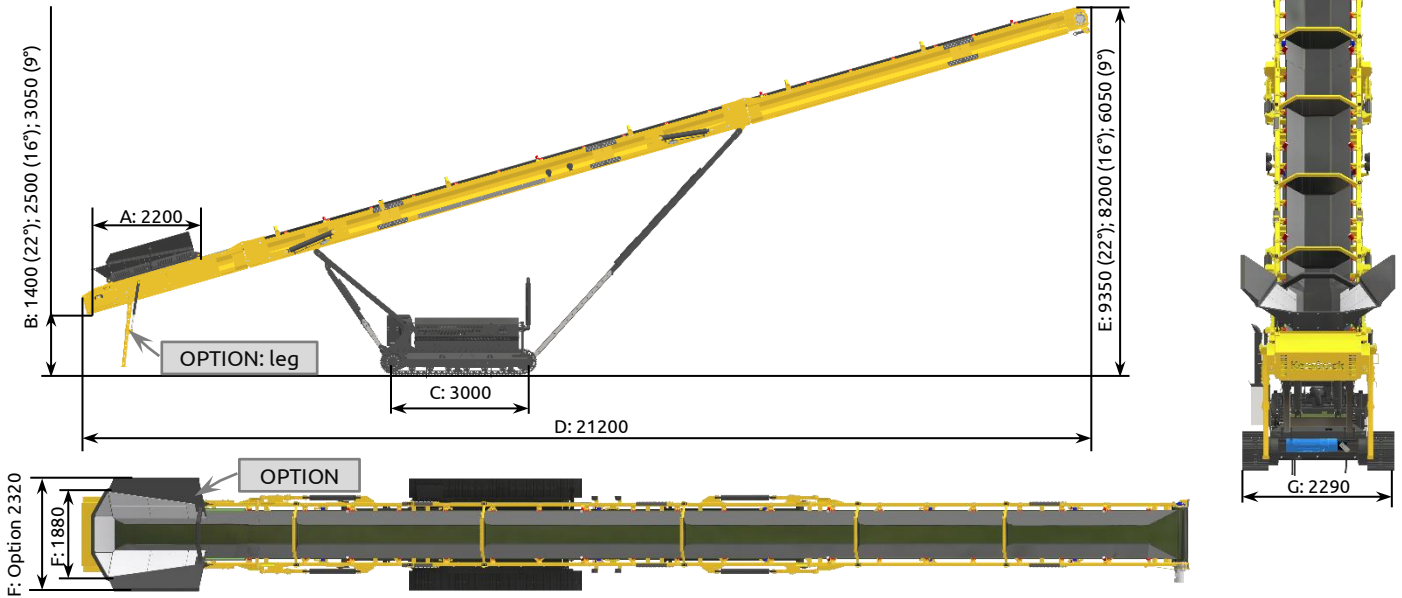

Weight: approx. 12 t (without options)

- Weight options:
- Wear lining feeding chute + approx. 193 kg
- Increased feeding chute + approx. 200 kg
- Hydraulic supporting legs + approx. 214 kg
- Electric drive + approx. 333 kg

Total weight with options approx. 13 t

Transport width 2.290 mm (9'10")



STACKERS

TRANSPORT:

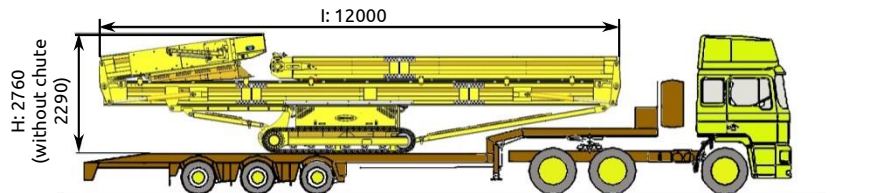

REMARK: All pictures might show options, not included in the scope of supply

A	B	C	D	E	F	G	H	H w/o chute	I		
2200	1400	3000	21200	9350	1880	2290	2760	2290	12000		
7'3"	4'7"	9'10"	69'7"	30'8"	6'2"	7'6"	9'0"	7'6"	39'4"		

TECHNICAL SPECIFICATION

APPLICATION:

Stockpiling of bulk goods (sand and gravel)

- Feed size	0 up to max. 200 mm	
- Feed capacity	Depending on the inclination of the conveyor: Inclination 22°: up to 300 T.P.H. (with engine 35,2 kW – p/n 103008) up to 500 T.P.H. (only with engine 55,4 kW – p/n 101322 and high pressure pump – p/n 689662)	
- Stockpile capacity	Depending on the swivelling of the conveyor (estimations: angle of repose 37 °; bulk weight 1,7 kg/dm³):	
	Swivelling 0 ° Inclination 22°	2.500 tons
	Swivelling 90 ° Inclination 22°	8.600 tons
	Swivelling 180 ° Inclination 22°	15.000 tons
- Possible Inclinations	In steps of approx. 2° from 9° to 22°	

1) FEEDING CHUTE

- Model	04 FEH 000000-000	
- Design	Made of St 520-3	
- Wear plates (Option)	Wear resistant steel HB 450; s=10 mm or rubber (4'7"-10'0")	
- Feeding height	1.400 – 3.050 mm; can be varied to higher (7'3") positions by swivelling the feed end of the conveyor hydraulically	
- Feeding length lateral	2.200 mm	

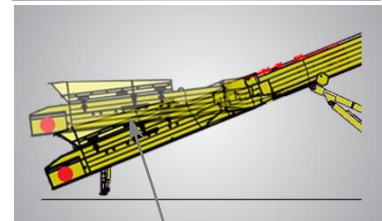
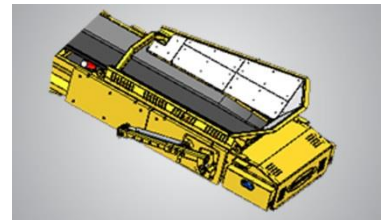

Swivelled-up feeding zone

2) MAIN BELT CONVEYOR

- Model	04 MCL 000000-000 H	
- Length	23.000 mm	(75'6")
- Width	1.000 mm	(3'4")
- Capacity	Up to 500 T.P.H.	
- Drive	Hydraulic 22,5 kW	(30,6 hp)
- Belt speed	Adjustable; max. 1,3 m/s	(0 - 20 ft/s)
- Rubber belt quality	EP 400/3 4+2	
- Troughing	30°; 3 parts	
- Feeding zone	With PU impact bars	
- For transport	2 x hydraulically fold-able	

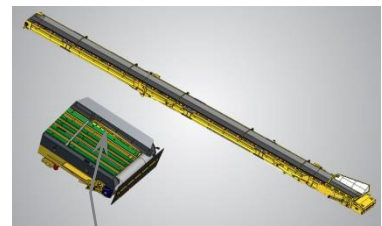

Feeding zone

3) TRACK - UNIT

- Model	04 TRA-100-00	
- Length	3.000 mm	(9'10")
- Width track shoe	400 mm	(1'6")
- Total width	2.290 mm	(7'6")
- Speed	1 km/h	(0,6 mph)
- Drive	Hydraulic motor and planetary gears	



TECHNICAL SPECIFICATION

4) ENGINE UNIT

- Model	04 ENU 000000-000	
- Diesel engine type	a) DEUTZ TCD 2.9 L4, 4 cylinder in-line b) DEUTZ D 2011 L 04, fixed speed	(p/n 101322) (p/n 103008)
- Emission control	a) Tier 4i; EU STAGE IIIB; DOC Option: DPF (p/n 101323) b) Tier 3; EU STAGE IIIA; EGR	Latest technology
- Power acc. to ISO 14396	a) 54 kW at 1.800 R.P.M.; 55,4 kW at 2.000 R.P.M. b) 29,4 kW at 1.500 R.P.M.	(65 hp; 75 hp) (40 hp)
- Max. torque	a) 300 Nm / 1.500 Nm b) 190 Nm / 1.500 Nm	(221 lb ft) (140 lb ft)
- Engine speed	1.800 R.P.M.	
- Bore / Stroke	a) 92 / 110 mm b) 96 / 125 mm	(3,6" x 4,3") (3,8" x 4,9")
- Displacement	a) 2.920 cm ³ b) 3.620 cm ³	(178 cu in) (221 cu in)
- Voltage	24 Volt; for improved cold start properties	
- Battery	110 Ah-850 A	
- Electrical starter	24 Volt; for improved cold start properties	
- Alternator	ECO 32-3L/4b; 26 Volt	
- Engine Operation	4-stroke Diesel direct injection	
- Cooling	a) water cooled b) air cooled	
- Fuel tank	230 litres	(60 gal)
- Fuel pre-filter	with water separator	
- Fuel code	according to DIN 51601	
- Consumption	a) 215 g/kWh / 1.500 R.P.M.; approx. 6 l/h b) 226 g/kWh / 1.500 R.P.M.; approx. 6 l/h	

Engine warranty expires in case non genuine Keestrack filters are used!

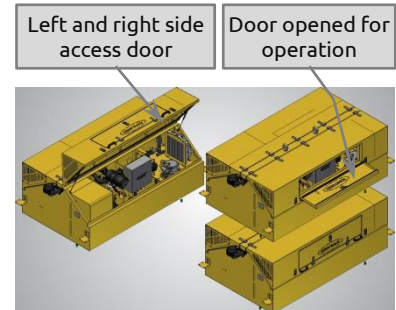

ATTENTION

5) HYDRAULIC

Hydraulic pump for tracks	Variable flow, swash plate pump load sense open loop circuit 45 cc	
Hydraulic pump for belt	loop circuit gear pump 38 cc; STANDARD: valve fixed speed OPTION: p/n 102739 valve for speed regulation	
Max. flow	81+68 l/min at 1.800 R.P.M.	(21 + 18 gpm)
Max. pressure	265 bar	(3.770 psi)
Pump regulation	servo hydraulic load sensing regulation, pressure compensation, flow compensation automatic flow optimizer	
Hydraulic tank	110 l	(34 gal)
Hydraulic oil filter	1 full flow filter in return line with integrated fine filter area (10 µm)	
Hydraulic oil cooler	Compact cooler, consisting of an electrical 12 Volt driven fan	
Hydraulic valves	PVG 32 proportional 3 bank valve	
Manual pump	25 ccm	
Hydraulic cylinders	A) folding and B) lifting of the conveyor (min./max. 9/22)	

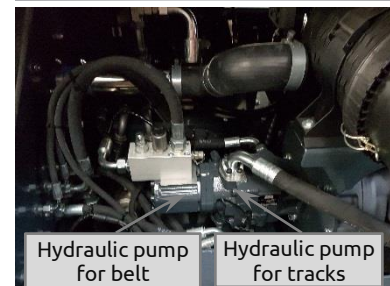
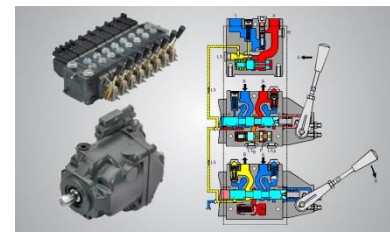

6) CONTROL

- Operation	Control panel
- Controller	Wired remote controller for tracks



TECHNICAL SPECIFICATION - OPTIONS

7) HYDRAULIC SUPPORTING LEGS p/n 704003

- Operation Hydraulically folded down
- For inclination 22°
- Length adjustment Mechanically
- Weight 214 kg (450 lb)

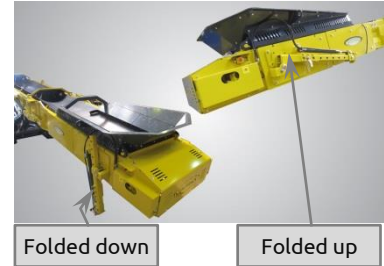

8) RADIO REMOTE CONTROL 1 with Display – Level 1

- Order no. Remote 103478
 Sticker 103207
- Functions - Tracks forwards / backwards
 - MCL start / stop
 - Machine stop button (blue)
 - Display



9) WORKING LIGHTS

- 4 lamps p/n 695970
 LED lights 12/24 V; 45 W
 each lamp: 9 pcs. LED's (p/n 205147)
 4500 Lumen
- protection degree IP69K
- Weight 9 kg (20 lb)



10) INCREASED POWER FOR BELT DRIVE p/n 689662

- System: Additional high pressure hydraulic pump (380 bar continuous, 41 ccm/rev.) with bypass valve for direct drive of belt conveyor (without energy loss in PVG) and special high pressure hydraulic motor for belt drive
- Hydraulic motor High pressure; 750 ccm/rev.
- Drive power belt conveyor 37 kW at 1.800 R.P.M. engine speed
- Belt speed 1,75 m/s at 1800 R.P.M.
- Feeding capacity stacker 500 T.P.H. at max. inclination 22°
- REMARK** only with engine 55,4 kW p/n 101322

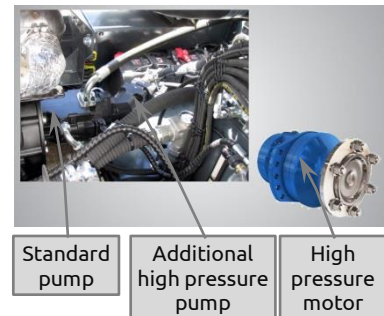

Standard pump Additional high pressure pump High pressure motor

11) ELECTRIC DRIVE p/n 695715 (22 kW); p/n 695725 (30 kW)

- Model 04 ELD 000000-000
- Drive Via E-motor a) 22 or b) 30 kW (1500 R.P.M.), (30 or 40 hp)
 clutch, gear pump 44 ccm
- Belt speed Adjustable via proportional valve
- Power supply External, 400 V; 3 Phase, 50 Hz; a) 65 A; b) 85 A min. to built-on socket on switch cabinet
- Weight 333 kg (700 lb)

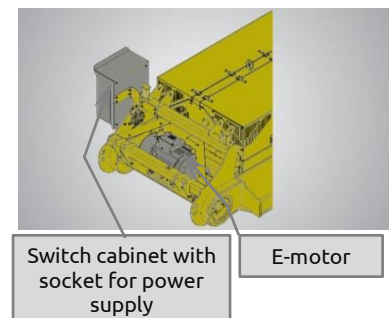

Switch cabinet with socket for power supply E-motor

STACKERS

TECHNICAL SPECIFICATION - OPTIONS

12) WEAR LINING FEEDING CHUTE p/n 701030

- Rubber p/n 704001; s = 10 mm
- Steel p/n 704002; s = 10 mm; HB 450
- Weight rubber 80 kg; steel 193 kg (400 lb)

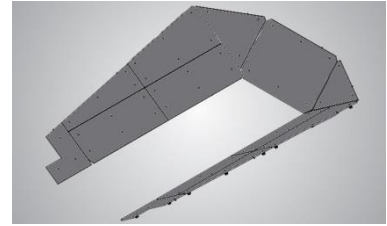

13) INCREASED FEEDING CHUTE p/n 695690 + 695695

- Width 2.320 mm (7'7")
- Sides Left and right side
- Transport Manually foldable
- Weight 200 kg (420 lb)

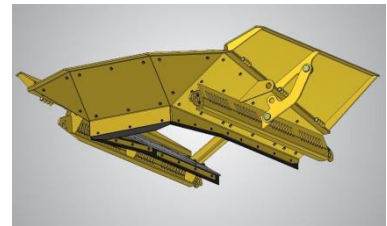

14) OIL LEVEL SENSOR p/n 105569

- Measuring signals Temperature and level

15) HARD METAL SCRAPER p/n 101807

- Location Drive drum



16) CHEVRON RUBBER BELT p/n 102905

- Rubber belt quality EP 400/3 4+2
- Cleats 750 mm x 25 mm



17) CHEVRON RUBBER BELT, ARCTIC DUTY p/n 100897

- Rubber belt quality EP 400/3 3+1
- Cleats 750 mm x 25 mm

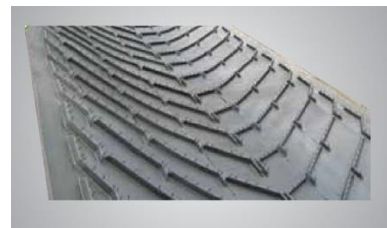

18) RUBBER PADS FOR TRACK CHAIN p/n 100632

- Arranged bolted to the track chain elements
- Number 106
- Dimensions 400 x 106 x 40 mm
- Weight 306 kg (650 lb)

